

Coorong Thriving Towns

Meningie

Wednesday 5 April, 2023





MENINGIE LIONS JUBILEE PARK

LANDSCAPE CONCEPT

EXISTING SITE FEATURES AND OPPORTUNITIES



EXISTING SITE FEATURES
NOT TO SCALE

CONCEPT PLAN



KEY AREAS	
01	NEW CAR PARKING WITH ACCESSIBLE PARKING BAY
02	PRIMARY PARK ENTRY FROM HIGHWAY
03	FLEXIBLE CENTRAL LAWNS (IMPROVED KICK-ABOUT SPACE THROUGH SELECTIVE TREE REPLACEMENTS)
04	SECONDARY PARK ENTRY FROM BOWLS CLUB
05	RECREATIONAL LAWNS
06	EXERCISE NODE
07	NEW LANDSCAPED AREAS SURROUNDING WISHING - WELL
08	FOOTPATH TO MATCH INTO EXISTING
09	NEW LANDSCAPE INCLUDING TREES AND PLANTING TO ENSURE FUTURE TREE CANOPY
10	NEW LANDSCAPED INTERFACE TO FOOTPATH: - STREET FURNITURE AND TREE PLANTING
11	PREFERRED PICNIC SHELTER LOCATIONS 1 AND 2

CONCEPT PLAN
NOT TO SCALE

EXERCISE EQUIPMENT OPTIONS



OUTDOOR MACHINE EQUIPMENT, SIMPLE USE, ACCESSIBLE DESIGN



STEEL FRAME POWDER-COAT COLOURS, INSTRUCTIONAL DIAGRAMS



SIMPLISTIC DESIGN FOR A RANGE OF AGES AND CREATIVE ENGAGEMENT



OPTIONAL INDIVIDUAL COMPONENTS



OPTIONS FOR CUSTOMISED EXERCISE PROGRAMS



NATURALISTIC MATERIALS, VERSATILITY OF RESISTANCE TRAINING EQUIPMENT

PICNIC SHELTER PRECEDENTS

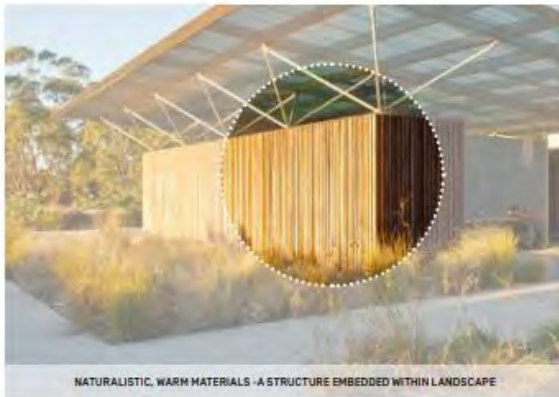
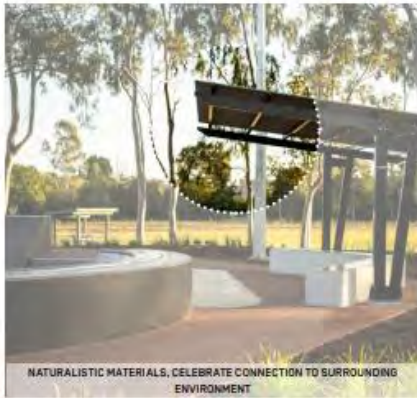













Meningie Jubilee Lions Park Community Engagement Findings Report

April 2023

Meningie Jubilee Lions Park Refurbishment

Community Engagement findings report. April 2023

Community Engagement

In accordance with Council's Community Engagement Policy, engagement for the Meningie Jubilee Lions Park refurbishment, was undertaken over a six (6) week period. During this time community members were invited to participate and provide feedback on the proposed refurbishment of the Meningie Jubilee Lions Park through either completing a submission form, providing feedback direct via email, phone and face to face or attending a community forum.

The submission form was developed around what the community liked, dislikes and wished to see included in the plan. The submission form also sought and encouraged additional feedback.

Council representatives met with the Meningie Lions Club to discuss the plans and explore further options and ideas which were captured and presented in this report.

A community forum was held on Wednesday 5 April 2023 with approximately 38 community members attending and providing valuable input and putting forward their thoughts and ideas for the Meningie Jubilee Lions Park refurbishment.

Council developed two (2) versions of the submission form which included an online version and a printed version. Access to these forms was also made available via Council's website, links via electronic and social media distribution, as well as printed copies located at all Council offices.

The findings and feedback obtained from 57 participating community members and stakeholders will be used to guide and assist in formulating the plans Meningie Jubilee Lions Park.

Community participation

Over 57 people contributed to the community engagement period:

- 37 people participated by attending the forum
- 7 people completed the online submission form
- 12 people completed a printed copy of the submission form
- 1 person made written submissions

Communications

Council commenced an extensive campaign to encourage participation, and this was carried out via various methods including:

- Media release distributed to over 37 regional media outlets.
- Full page advertisement in the Meningie Lakelander.
- Online digital submission form developed and distributed.
- One separate e-newsletter distributed to over 1,300 subscribers
- Facebook posts scheduled:
 - 29 March 2023 – reached 555 people
 - 2 April 2023 – reached 303 people
 - 4 April 2023 – reached 672 people
 - 9 April 2023 – reached 350 people
 - 18 April 2023 – reached 193 people
 - 21 April 2023 – reached 233 people
- Facebook event for the Community Forum created and shared
- Presentation to the Meningie Lions Club on Thursday 9th March approximately 12 members in attendance
- A3 Posters created and displayed at high traffic points
- One (1) Community forum held with 38 members of the public in attendance

Findings from the community engagement process will be used to guide the next steps in the process of determining and understanding the community's aspirations for the Meningie Jubilee Lions Park refurbishment project.

Summary

Community engagement participants provided feedback and input into four (4) key questions around what they liked, disliked and whether they wished to see additional inclusions in the plan.

Within the responses emerged a range of themes and these themes will help to guide Council on the plans for the Meningie Jubilee Lions Park.

Engagement feedback

The following topics and information is a synthesis of feedback captured during the workshops, conversations and via submission forms.

What do you like about the draft Meningie Lions Jubilee Lions Park Concept Plan?

- Making it safe
- Interconnecting footpaths for inclusion.
- Sealing and extension of parking near hub.
- Replacement of the exercise equipment
- Greater parking
- Further upgrade - very positive
- Not Much.
- There are far too many plantings in the park and needs more open spaces"
- Good in Parts
- Some good Suggestions
- The pelican Sculpture was a great landmark and popular with Tourists a similar replacement would be a good idea. ""if it aint broke, don't fix it"
- Barbeques needed rehab.
- Parking is a great improvement.
- Need good appropriate replacement for pelican.
- Tree planting good if proper species (ie Non Invasive) are chosen"
- Not too bad
- Not Bad, But at least one of the shelters should be larger to accommodate larger groups like buses and even the Lions Club activities.
- Please cost replacement of Pelican Sculpture in hardwood to place next to footpath going to play ground"
- More shade
- I generally accept the proposed new layout

- I genuinely believe Meningie has had more than enough money spent on it with their Streetscape project, which we are still paying off. Please advise the Ratepayers on how much is still owed on the project.
- The new picnic areas and new parking.
- I like that the Meningie park is getting some upgrades.
- Looks good
- Upgrade of the exercise equipment
- Some Ok. Playground, Gym Equipment
- The pathways and new bbq area

What do you dislike about the draft Meningie Lions Jubilee Lions Park Concept Plan?

- I don't like the idea of the car charging points in that area
- Wheelchair access not showing.
- The style of the shelters
- Just like trees not snakey grasses which are also more maintenance for CDC workers and volunteers
- Cautious about charging stations taking up valuable parking space for other users
- Refer to #3
- "Tree planting along bowls club boundary could be removed (root Damage to Bowling green surface).
- There can be too many trees and not enough space"
- The tree plantings along the edge of the Bowling club (9) need to not have roots that will causer trouble with the green of the bowling club (Croquet Club)
- Open area designed for Marquees (or) just open area fro families to enjoy
- Charging station need to be moved oput of bottleneck area"
- Not enough shade
- 1/.. Disability Parking to be provided in close proximity to the new pathways (Item 8)
- 2/.. Wishing wells (Item 7) in general are outdated in concept and might be better incorporated into a water feature/sculpture
- 3/.. Vehicle Access to southern park area particularly Ambulance. This might be accommodated with Item 8 giving access to shelter sheds, playground and Gym
- I dislike the fact Meningie are wanting more money spent on their town, with so many other towns in the district needing upgrading.
- The no changes to existing playground. The existing playground is only suitable for children above 5 years old as it is very high and steep.
- Lack of safety considerations
- Nothing in particular
- The shelters, they need to have solid walls and roof. Meningie is a stopping point for people to get out and stretch at all times of the year. It is windy and rainy from different directions. Car park off the main road (caravans will think they can). Need wind protection.

- Too Cluttered in around Bowling Club – Not enough parking – especially for cars/ caravans.
- Electric Car points to go down near ostrich or Melaleuca vacant block opposite AMPOL road house
- Keep area open except for a few trees and picnic shelters
- The potential for bottlenecking bowling club entry by refueling bowsers and car parking

Would you like to see anything added to the Concept Plan?

- A Wi-Fi and Mobile (USB)charging station that caters for all services not just Telstra like the one at Milang maybe.
- More Power Points for events
- "Extra power supply throughout the park for community events.
- Also lighting, extra seating under shade trees.
- Charging station for electric cars somewhere in town and not necessarily in the Lions Park"
- "Need a permanent speaker system in the park
- Need More electricity points (Bollards)"
- More Historical photos and descriptions
- An art piece representative of our community / area
- Choice of waterfront plantings to reflect future high water events and perhaps be species to encourage birds and create habitat
- Vehicle access to grassed area for fairs etc
- "Vehicle access
- A notice board for local events etc"
- "A larger BBQ shelter for larger groups - Roadside of horizontal walking path.
- Please look at a windproof product called ""winterlite"" made in SA Adelaide! See through, wind and rain proof"
- More shaded areas to stop and sit...read etc
- The reconciliation sculpture, previously Nori the Pelican. This could be relocated to the northern portion of the park
- Nothing
- I would like to see a toddler playground/ play area added which is not as high or steep. I would also like to see a safety fence around the playgrounds as it is very close to Lake Albert and the main road.
- Safety measures around the playground. On one side of the playground there is water and the other a busy Highway. There needs to be more safety considerations for the children, appropriate fencing around the playground.
- I'd like to see a water station added for filling water bottles.
- Move seating at Northern end and more parking
- Removal of building adjacent to office so car parking can be achieved but make it bigger by starting parking at the front of the rubber matting not the back. You lose a

little bit of the park but in the long run will be safer as cars will have more room space to Back out and hopefully less accidents.

Do you have any further feedback?

- "Meningie Heritage - Round Roof for shelters plus including windbreaks.
- Rejuvenate swimming beach - extremely rocky and cuts feet of small children"
- "Remove pine trees / replace with other
- Vehicle access - re food fair and markets"
- Toilet Block is very well used, clean and functional " Great Work Coorong Council"
- How do you propose to keep caravans or Large RV's out of the proposed new parking area
- I would like plantings to be local native species to encourage birds and create habitat.
- "Keep the rose garden.
- Ian Qualmans suggestions need to be considered strongly.
- Please remember that the Lions Clun has and average age of 72. Don't expect volunteers to do more physical work than they already do in regard to getting and erecting marquees 5 times a year "
- All shelter areas roofs need to be sloped away from prevailing W-SW winds; incorporating solar panels feeding a concealed recharge battery for lighting and e-device charging stations
- As for replacing the Pelican sculpture, once again Meningie has had more than their share of Ratepayer's money. Even if they receive a grant for 100% of the cost of ANOTHER sculpture (let's not forget they have also got the Boat sculpture) Who is then going to pay for the upkeep of the sculpture, Council (with Ratepayers money)? Please stop spending money in Meningie and give the other towns the things they really need.
- I believe there should also be more bins added in more convenient areas as often the bins are overflowing and rubbish flies everywhere.
- Increasing the tree canopy is great.
- Would like to see Pelican done in fibreglass, similar to Ostrich but not as tall as I have noted family, friends and visitors ask where it has gone. The original Pelican was only meant to last 15 years (Pine Tree) anyway and most of the cost was renting old Lutheran church for people carving.
- Yes replace the pelican sculpture with replica in a hard wood that won't rot.

The following feedback was provided from the Meningie Lions Club (numbers reference points on the plan)

1. Speaking to members of the public most are in favour of making this area a good off street vehicle park with possible charging stations, with the removal of the old laundry building, making this a much larger parking area.If this occurs this area to be constructed to street standards, kerbs, drainage and sealed with signage to stop

caravan trying to access this current area. This would reduce the added congestion during bowling season along the main street, with the building removed would adequately cater for bowlers and visitors.

2. No number, gather main access still along Main street and future bowling/Laundry car park area.
3. Kick about space ? may be a better location north of toilet block towards the boat ramp, have reason for this suggestion with point 11 (shelters locations)
4. Good suggestion allow access to playground and other facilities through the park especially for wheel chair access
5. No problem with lawns, only thing later on all lawns will need thinning out to reduce soft sponge surfaces.
6. Good location, need to be robust and water resistant materials due to lake water irrigation and I have personally seen Jim equipment (4 in 1 design) as shown on page 4 of the plan, this equipment doesn't take up much space or could be located on lakeside of the proposed Blue marked area.
7. Landscaping around wishing well area, Lions would like to retain the well, with a new facelift around bricks (profile cutter design e.g. matching bin cover design) and new roof to match new building designs.
8. Good layout of footpaths, better access for wheelchairs and goffers across this area, there is a lack of access from footpath to pelican path on the northern end. May be a diagonally footpath to lake ?
9. Congratulations since the introduction of the newer trees that seem to be growing well, would create more shelter and shade. May require consultation with Bowling Club with the suggested plantings along northern fence adjacent to current croque court, may have future root damage to surface"
10. A good mixture of furniture and trees, suggest a few more seats along the north side towards Boat in rose garden.
11. Firstly, the suggested design shelter as presented on page 4, are suited for more sheltered environment. Suggest that there be two shelters, the first one which is near the playground to be moved back into lawn area (3) as a bigger shelter to accommodate families or bus groups on the same angle with access from car park will remain the same, this would allow visual sighting to playground with appropriate shelter constructions along the southern side to reduce rain and wind.
The other shelter near the toilets to be moved down towards the lake among the trees near the board walk area to allow both BBQ areas spread over a larger area, again will require some shelter strips to reduce wind activity.
The current power source to the current BBQ shelter to remain and converted into a power access pole, same as the poles within the northern area of the park.
With the location of BBQ shelters, planning will be required to readjust the current irrigation spray locations to reduce spray over BBQ areas.
With the new shelters will there be access to water, will they have power points and seating.

The following comments and feedback were captured during the evening of the Community Forum held on Wednesday 5, April 2023

- Meningie Lions Club
 - Refer to written submission.

- BBQ Shelters
 - One bigger to accommodate bus companies, larger gatherings and driver reviver
 - Wind shelter
 - Solar Panels – USB charging picnic tables
 - Larger shelter
 - A lot more work to be done on what the shelters will be – reference to the dog park shelter, no shelter, shade. Perhaps a bit of curving. 4 leg skillion roof a theme and we need something much, much, better
 - Similar to the ones at Milang – low roof and big area

- Rose Garden
 - Positive comments re the flower garden
 - Please do not remove
 - I hope the rose garden will stay
 - Extend the rose garden to the footpath like the other end and make this all open so all can see
 - More flower beds

- Trees
 - The pine trees.
 - Too many trees highlighted on the plans.
 - The park offers great view of the lake for visitor to the region and encourages them to stop. These trees will hide the view.
 - Positive feedback from visitors regarding the lovely park and why put trees in to hide the view
 - Less trees

- Open space – RH side of toilets
 - Loudspeaker system
 - Vehicle access for events etc
 - Nothing else really needed as they are already scratched for space.
 - More Lighting
 - More Power

- Gym equipment
 - Like the location

- Car park
 - If the laundry doesn't go, there really is not much room for a car park it could move into the park for more room

- Old Laundry Block
 - Need demolishing emergency services use the area and can be difficult are to use
 - Drive around the building
 - Activities undertaken in the laundry building at the moment could be moved down to Wadmore house
 - Hasn't been a laundry for 40 years – used to be the laundry to the caravan park.
 - The building is used by SES, the Lake Lander and Council and Parkrun for storage, so if you say get rid of the building you will need to find another place for all those that use it. Bear in mind that it is definitely used

- RAA Charging Stations
 - Move to another location
 - Bottleneck and congestion
 - Move to Melaleuca
 - Consideration around the size of cars, vehicles and trucks. Future requirements. The proposed location will be a bottle neck.
 - With the car parking for the charging stations, and if they are able to be used for ordinary parking they will always be full and anyone wanting to used them will not be able to as there is not enough parking around the streets of Meningie at the moment
 - Could be friction if cars park there
 - Congestion and already congested space can it go to the area at the CFS shed or the Wadmore house precinct – this way moving the traffic along the road and opportunities further up the road

- Swimming area in park
 - It was very rock y and kids ended up with cuts on their feet
 - Signage very poor doesn't indicate if you can swim there, is it safe etc

- Footpaths
 - Universal design principles
 - Footpaths to BBQ shelters and playground
 - Creating connections

Community Forum - Post it note feedback:

- The large area on the right-hand side of the toilet block kept as it is. Needs to have this for events like the food fair
- More lighting and power required in this area
- Shelter located near footpath for driver reviver
- More power outlets for events
- Single cubicle toilets – more family friendly
- Wheelchair access to the lake footpath
- Vehicle access required from both ends of the park
- Another footpath from street to pelican path (centrally located)
- Larger BBQ shelter required for Large / Bus groups / Driver reviver
- Configure area around old laundry – drive around – consider angle parking
- RAA charging points relocated to Ostrich
- Leave the rose garden
- No trees near bowling club
- Remove old laundry
- No charging stations near Info Hub – too much congestion
- No trees – leave it open
- This is a concept plan. There are an abundance of trees on the road side. Once on a plan these concepts quickly become permanent
- More cars coming out of driveway then turn right – very big hazard
- Love the replacement of the exercise equipment
- Solar Panels and USB charge stations in shelters
- Extra seating under shade
- Retain existing flower beds – don't create more work for volunteers and CDC workers
- Need more power points
- Need permanent speaker system
- Vehicle access for markets and food fair

Community Engagement Outcomes

At the conclusion of the community engagement the Council staff undertook a review of the information and feedback provided by community members and gathered during community meetings and forums.

Emerging throughout the feedback were a range of key themes and these have been captured and presented below.

Key themes

1. Shelters
 - a. Increase the size to accommodate large groups and bus companies.
 - b. Locate the larger of the two closest to the footpath.
 - c. Review of style
 - d. Consider solar panels and the installation of charging ports.
2. Car Park
 - a. Consider new location for the charging stations
 - b. Consider removing old laundry.
3. Trees / garden
 - a. Considerations around not planting trees that block views.
 - b. Reduce the number of proposed trees
 - c. No trees near the bowling club
 - d. Retain rose garden
 - e. Plantings to be local native plants
4. Open space
 - a. Right Hand side of the toilets to remain as is
 - b. Power bollards
 - c. Additional lighting
 - d. Installation of a loudspeaker system
5. Footpath Connectivity
 - a. Toilets to shelters
 - b. Footpath to shelters
 - c. Carpark to shelters
 - d. Directly from footpath through park and to the lake front
6. Vehicle Access
 - a. Provide access for vehicle at both ends of the park – for community events